

IEN Series

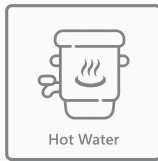

FLUUX IEN Series



Enhance Taste and Extend Machine Life,

Advanced Solutions for Coffee Experts.



VHC-IEN

Pure, Safe, Better with NSF certified Carbon block!
Protects your equipment and delivers
the best coffee flavor.



Cleaner Water with High-End Carbon Block Solutions

Microfilter's carbon blocks deliver excellent performance, effectively reducing fine particles and impurities to provide cleaner, clearer water. Enhanced particulate reduction improves extraction quality while helping prevent early scale formation—offering a filtration solution you can trust.

Stronger Scale-Inhibition Technology

The VHC filter contains scale-inhibiting additives that help reduce limescale buildup, corrosion, and internal component wear. This improves equipment efficiency, extends the lifespan of key parts, and reduces maintenance requirements.



Optimized, Shorter Flushing

Microfilter's carbon blocks generate significantly fewer fines compared with standard activated carbon products. Their reduced fine release allows stable performance with minimal flushing before use.



A Multi-Solution Filter Designed for Stand-Alone Performance

- 01 Sediment Reduction**
Effectively reduces coarse particles such as rust and debris.
- 02 Hardness Control**
The 4.2–4.6 eq/L high-capacity ion-exchange resin [reduces hardness-causing minerals](#), [helping prevent early scale formation and protecting the machine](#). Its FLUUX-engineered resin formulation also helps maintain proper pH balance for consistent water taste.
- 03 Fine Particle Reduction**
Captures fine particulate matter to deliver cleaner and clearer water.
- 04 Scale Prevention**
Minimizes limescale buildup inside the equipment, helping maintain heat-exchange efficiency. For systems that require it, installation with a bypass valve is also possible.
- 05 5µm Carbon block improves Taste & Odor**
The 5µm carbon block reduces 5µm fine particles and reduces unpleasant tastes and odors, providing fresher-tasting water.
- 06 8-Level Bypass Adjustment**
The VH head system allows precise control of inlet water as it passes through the ion-exchange resin, enabling you to blend to your desired hardness level.



VHC IEN-Series		VHC IEN 1500	VHC IEN 3000
Capacity (L) (30% bypass) Hardness Level (180 ppm as CaCO ₃ / 10° dH)		2,004	4,569
Pore Size		5µm	5µm
Cups per Day (Based on 100 ml)		~130 cups	130~270 cups
Product Dimensions (mm)	W	113	113
	D	119	119
	H	350	406
Product Weight (kg)		1.5	2.1
Operating Temperature		4-38°C (Use within recommended water temperature range)	
Operating Pressure		30 - 100 psi	
Inlet/Outlet Size		3/8" or 1/4" fitting	

VH-IEN

Designed for control hardness level,
Ensuring stable and consistent coffee quality.



8-Step Bypass Adjustment System

The filter allows precise control of hardness levels, offering up to 8 blending steps to match a wide range of applications



Application	8-Step By-Pass							
	Level 0	Level 1	Level 2	Level 3	Level 4	Level 5	Level 6	Level 7
Coffee / Espresso Machines			■	■	■	■	■	■
Vending Machines			■	■	■	■	■	■
Rinse & Dishwasher Equipment	■	■						
Ovens / Steamers	■	■						

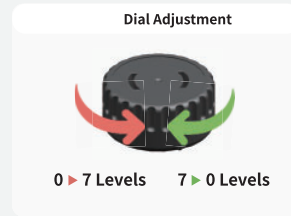

A refined system that lets coffee experts tailor water hardness for ideal taste.

- 01 Sediment Reduction**
Effectively reduces coarse particles such as rust and debris.
- 02 Hardness Control**
The 4.2–4.6 eq/L high-capacity ion-exchange resin [reduces hardness-causing minerals](#), [helping prevent early scale formation and protecting the machine](#). Its FLUUX-engineered resin formulation also helps maintain proper pH balance for consistent water taste.
- 03 Fine Particle Reduction**
Captures fine particulate matter to deliver cleaner and clearer water.
- 04 Activated Carbon Filtration**
High-quality coconut carbon reduces chlorine and unpleasant flavors, delivering clean, refreshing water.
- 05 Fine Particle Reduction**
Reduces fine particles to deliver clean, clear water.
- 06 8-Level Bypass Adjustment**
The VH head system allows precise control of inlet water as it passes through the ion-exchange resin, enabling you to blend to your desired hardness level.

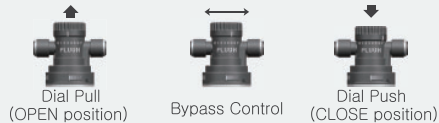

VH IEN-Series		VH IEN 1500	VH IEN 3000	VH IEN 6000	VH IEN 9000
Capacity (L) (30% bypass)					
Hardness Level (180 ppm as CaCO ₃ / 10° dH)		2,004	4,569	9,874	13,805
Cups per Day (Based on 100 ml)		~130 cups	130~270 cups	270~550 cups	550~800 cups
Product Dimensions (mm)	W	113	113	151	151
	D	119	119	151	151
	H	350	406	408	549
Product Weight (kg)		2.0	2.3	3.4	5.5
Operating Temperature		4 - 38°C (Use within recommended water temperature range)			
Operating Pressure		30 - 100 psi			
Inlet/Outlet Size		3/8" or 1/4" fitting			

IEN

A fixed 30% bypass that ensures stable system output.
Designed to protect high-performance brewing equipment.
Delivers consistent extraction and refined cup quality.





Fixed-Bypass System

A quick-change head enables fast and easy filter replacement. Provides stable performance through precise bypass control. Delivers a clean, balanced mineral composition.

Consistently Balanced Water Quality

Specialized ion-exchange resin stabilizes pH over long use, preserving a clean and consistent taste profile.

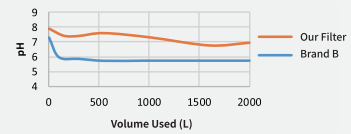

Reliable Scale Reduction for Machine Protection and Stable Coffee Quality

01 Sediment Filtration
Reduces coarse particles such as rust and suspended solids.

02 Hardness Control
The 4.2–4.6 eq/L high-capacity ion-exchange resin [reduces hardness-causing minerals](#), [helping prevent early scale formation and protecting the machine](#). Its FLUUX-engineered resin formulation also helps maintain proper pH balance for consistent water taste.

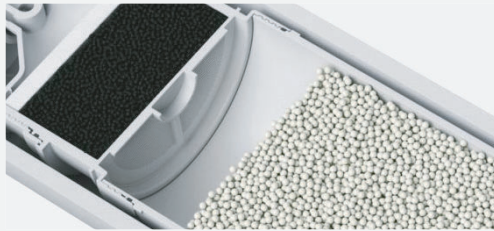

03 Fine Filtration
Captures finer particulates to improve overall water clarity.

04 Activated Carbon Filtration
Coconut-shell activated carbon reduces off-flavors and odors, enhancing taste and aroma

05 Post Filtration
Provides final polishing filtration for stable and consistent water quality.



IEN-Series	IEN 1500	IEN 3000	IEN 6000	IEN 9000
Capacity (L) (30% bypass)	1,500	3,000	6,000	9,000
Hardness Level (180 ppm as CaCO ₃ / 10° dH)	1,500	3,000	6,000	9,000
Cups per Day (Based on 100 ml)	70~100 cups	100~200 cups	200~350 cups	350~550 cups
Product Dimensions (mm)	W	113	113	151
	D	119	119	151
	H	353	409	406
Product Weight (kg)	2.0	2.3	3.4	5.5
Operating Temperature	4-38°C (Use within recommended water temperature range)			
Operating Pressure	30 - 100 psi			
Inlet/Outlet Size	3/8" or 1/4" fitting			

Product Specifications

VHC IEN-Series		VHC IEN 1500	VHC IEN 3000
Capacity (L) (30% bypass) Hardness Level (180 ppm as CaCO ₃ / 10° dH)		2,004	4,569
Pore Size		5µm	5µm
Cups per Day (Based on 100 ml)		~130 cups	130~270 cups
Product Dimensions (mm)	W	113	113
	D	119	119
	H	350	406
Product Weight (kg)		1.5	2.1
Operating Temperature		4-38°C (Use within recommended water temperature range)	
Operating Pressure		30 - 100 psi	
Inlet/Outlet Size		3/8" or 1/4" fitting	

VH IEN-Series		VH IEN 1500	VH IEN 3000	VH IEN 6000	VH IEN 9000
Capacity (L) (30% bypass) Hardness Level (180 ppm as CaCO ₃ / 10° dH)		2,004	4,569	9,874	13,805
Cups per Day (Based on 100 ml)		~130 cups	130~270 cups	270~550 cups	550~800 cups
Product Dimensions (mm)	W	113	113	151	151
	D	119	119	151	151
	H	350	406	408	549
Product Weight (kg)		2.0	2.3	3.4	5.5
Operating Temperature		4 - 38°C (Use within recommended water temperature range)			
Operating Pressure		30 - 100 psi			
Inlet/Outlet Size		3/8" or 1/4" fitting			

IEN-Series		IEN 1500	IEN 3000	IEN 6000	IEN 9000
Capacity (L) (30% bypass) Hardness Level (180 ppm as CaCO ₃ / 10° dH)		1,500	3,000	6,000	9,000
Cups per Day (Based on 100 ml)		70~100 cups	100~200 cups	200~350 cups	350~550 cups
Product Dimensions (mm)	W	113	113	151	151
	D	119	119	151	151
	H	353	409	406	547
Product Weight (kg)		2.0	2.3	3.4	5.5
Operating Temperature		4-38°C (Use within recommended water temperature range)			
Operating Pressure		30 - 100 psi			
Inlet/Outlet Size		3/8" or 1/4" fitting			

Additional Accessories (Sold Separately)

***Hardness Test Kit (2 Tests)** A kit used to measure the hardness of water.

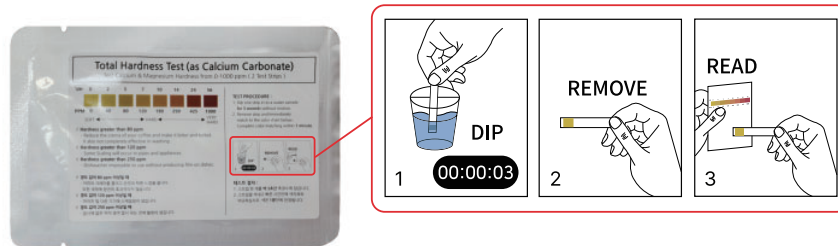

***Filter Stand** A stand used to support and stabilize the filter during installation or use.



*The content and images in this catalog are provided to help customers understand the product.

*Product appearance and performance may change without prior notice as part of ongoing improvements. Actual product colors may vary slightly due to the printing process. (Based on December 2025 data)

